

PCB	HJR-3FF
------------	----------------

- 10A switching capability
- Small footprint
- Sealed type available
- Class B/F available
- Conform to RoHS,ELV directive



ORDERING CODE

<u>HJR-3FF</u>	<u>S</u>	<u>H</u>	<u>F</u>	<u>(TBF-1)</u>	<u>/ 12VDC</u>	<u>/ IT</u>
1	2	3	4	5	6	7
1. Relay Model				4. Temperature Range		5. Insulated Level
2. S				F: UL/TUV 105°C		TBF - 1: Class F
3. H: Form A				VDE 85°C		Nil:
Z: Form C				Nil: UL/TUV 85°C		6. Coil Nominal Voltage
				VDE 70°C		3,5,6,9,12,18,24,48VDC
						7. GWIT
						IT: 750°C (at 2 s)
						Nil:

COIL DATA (at 20°C)

Nominal Voltage (VDC)	3	5	6	9	12	18	24	48	0.36W
Coil Resistance ($\Omega \pm 10\%$)	25	69	100	225	400	900	1600	6400	
Rated Current (mA)	120	71.4	60	40	30	20	15	7.5	
Max Operate Voltage (VDC)	2.25	3.75	4.5	6.75	9	13.5	18	36	
Min Release Voltage (VDC)	0.15	0.25	0.3	0.45	0.6	0.9	1.2	2.4	
Max Applicable Voltage	70°C 130%, 23°C 170%								

CONTACT DATA

Contact Form	1H/1Z	
Contact Material	Silver Alloy	
Load	Resistive load(COS Φ =1)	
Contact Ratings	1H:10A 240VAC 12A 120VAC	1Z: 7A 240VAC 10A 120VAC
Minimum load	100mA 5VDC	
Max Switching Voltage	250VAC/30VDC	
Max Switching Current	15A	
Max Switching Power	2770VA/240W	
Contact Resistance	100m Ω Max at 6VDC 1A	
Life Expectancy	Electrical : 100, 000 Operations(at30Operations/minute)	
	Mechanical : 10, 000, 000 Operations(at300Operations/minute)	

■ CHARACTERISTICS DATA

Insulation Resistance	100M Ω Min at 500VDC
Dielectric Strength Between Open Contacts	750VAC(50/60Hz for one minute)
Between Contacts and coil	1500VAC(50/60Hz for one minute)
Operate Time	10ms
Release Time	5ms
Temperature Range	-40°C to +85°C (or 105°C)
Shock Resistance	Operating Extremes : 10G
	Damage Limits : 100G
Vibration Resistance	10-55Hz, 1.5mm
Max. switching frequency	Mechanical: 18,000 operations/hr
	Electrical: 1,800 operations/hr
Humidity	40-85%
Weight	Approx 10g
Safety Standard	UL cUL TÜV CQC VDE

■ APPROVED STANDARDS

Model	Coiling rating	Safety Standard	Contact rating
HJR-3FF	3 to 48VDC	TÜV	1H: 15A 125VAC 10A 240VAC
			1Z: 15A 125VAC 7A 240VAC
		UL/cUL	1H: 10A 240VAC 12A 120VAC
			1Z: 7A 240VAC 10A 120VAC
			1/8HP(FLA 3.8A) 125VAC
			1/8HP(FLA 1.6A) 277VAC
		VDE	1H: 7A 250VAC/30VDC
			1Z: 7A 250VAC/30VDC
			H F: 10A 250VAC; 10A 30VDC
			Z F: 10A 250VAC; 10A 30VDC
CQC	7A 240VAC 10A 240VAC		

■ ENGINEERING DATA

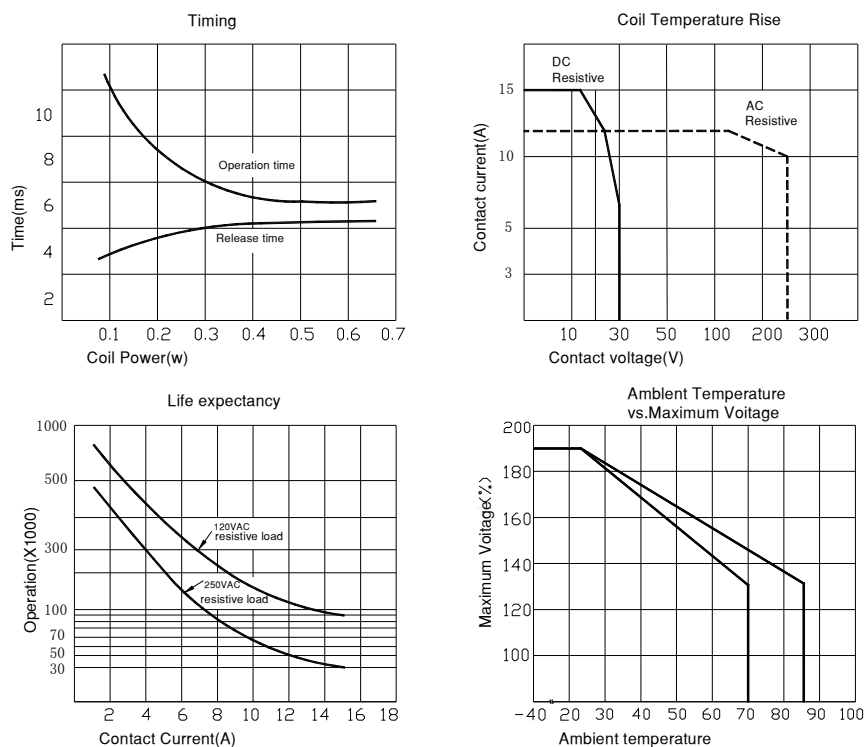

Indian Technological Products Private Limited

22-23, Type-B, Hartron Complex, Electronic City, Sector-18, Udyog Vihar, Gurgaon -122 016, Haryana (India)
 Telephone: +91-124-4013646, 4013647 Fax: +91-124-2398277 Email: info@itpindia.in www.itpindia.com

■ OVERALL AND MOUNTING DIMENSIONS

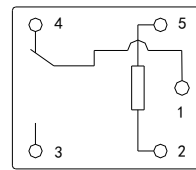
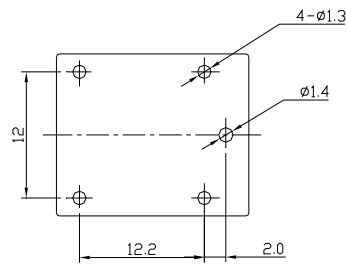
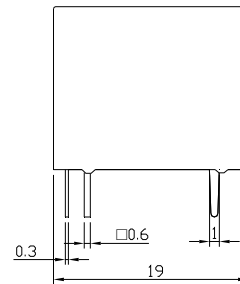
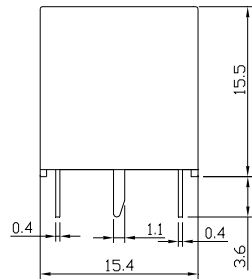

Form C

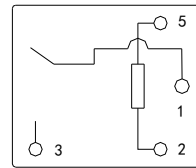

Form A